

FEATURES

- 40A switching capabilities
- PCB coil terminals, ideal for heavy duty load
- Insulation system - Class B: 130°C and Class F: 155°C
- 4KV dielectric coil to contacts
- Open, sealed or dust cover type available
- UL and CUL approval, File No.: E179937

CONTACT DATA

Contact form	1 Form A, 1 Form B & 1 Form C
Contact resistance	$\leq 50\text{m}\Omega$
Contact rating	
High power type	NO: 40A/240VAC 40A/30VDC, NC: 30A/240VAC 30A/30VDC (0.9W) NO: 30A/277VAC 30A/28VDC, NC: 20A/277VAC 2HP 250VAC
Standary type	NO: 30A/240VAC 30A/14VDC, NC: 20A/240VAC 30A/14VDC 1.5HP 250V
Max. switching power	1100W 7200VA
Max. switching voltage	110VDC 250VAC
Max. switching current	40A
Contact material	AgNi/AgSno
Weight	Approx. 37g

CHARACTERISTICS

Insulation resistance	1000M Ω at 500VDC
Dielectric strength	Between coil and contacts: 2500VAC, 50Hz T: 4000VAC, 1 min. Between contacts: 1500VAC, 50Hz
Operate time	≤ 15 ms
Release time	≤ 10 ms
Vibration resistance	10 to 55Hz double amplitude 1.5mm
Shock resistance	200m/s ² 11ms
Humidity	85% (at 40°C)
Ambient temperature	Class B: DC: - 55°C to +85°C AC: - 55°C to +60°C Class F: DC: - 55°C to +105°C AC: - 55°C to +85°C
Life expectancy	
- Electrical	1 x 10 ⁵ operations min.
- Mechanical	1 x 10 ⁷ operations min.

COIL SPECIFICATIONS – 1. DC Voltage (Standard)

Nominal voltage (VDC)	Pick-up voltage VDC (Max.)	Drop-out voltage VDC (Min.)	Nominal current (mA \pm 10%)	Coil resistance ($\Omega \pm$ 10%)	Power consumption(mW)
3	2.25	0.3	300	10	900
5	3.75	0.5	180	28	900
6	4.5	0.6	150	40	900
9	6.75	0.9	100	90	900
12	9	1.2	75	160	900
15	11.25	1.5	60	250	900
18	13.5	1.8	50	360	900
24	18	2.4	37.5	640	900
36	27	3.6	25	1440	900
48	36	4.8	18.8	2560	900
110	82.5	11	8.2	13445	900

2. DC Voltage (Sensitive)

Nominal voltage (VDC)	Pick-up voltage VDC (Max.)	Drop-out voltage VDC (Min.)	Nominal current (mA \pm 10%)	Coil resistance ($\Omega \pm$ 10%)	Power consumption(mW)
3	2.25	0.3	200	15	600
5	3.75	0.5	120	42	600
6	4.5	0.6	100	60	600
9	6.75	0.9	66.7	135	600
12	9	1.2	50	240	600
15	11.25	1.5	40	375	600
18	13.5	1.8	33.3	540	600
24	18	2.4	25	960	600
48	36	4.8	12.5	3840	600
110	82.5	11	5.5	20167	600

2. AC Voltage

Nominal voltage (VAC)	Pick-up voltage VAC (Max.)	Drop-out voltage VAC (Min.)	Coil resistance ($\Omega \pm$ 10%)	Power consumption
12	9	3.6	27	2VA
24	18	7.2	120	2VA
110	82.5	33	2360	2VA
120	90	36	3040	2VA
220	165	66	13490	2VA

ORDERING INFORMATION

ME-19F - 1 - A 012 6T 1H S F P L

Model No.	Type	Coil Input	Coil Voltage	Mounting & Termination	Contact Form	Protection	Insulation system	Load	Sensitivity
ME-19F	1, 2, 3, 4, 5 & 6 Type	Nil: DC A: AC	DC: 3VDC – 110VDC AC: 12VAC – 220VAC	Nil: 4 Pins (SPST) 5 Pins (SPDT) 6: 5 Pins (SPST) 6 Pins (SPDT) K: 3/16 coil terminal I: 1/9 coil terminal Nil: 2500VAC, coil to contact T:4000VAC,coil to contact	1H: 1 Form A 1D: 1 Form B 1Z: 1 Form C	Nil: Open S: Sealed C: Dust cover	B: Class B F: Class F	Nil: 30A/240VAC P: 30A/277VAC, 40A/240VAC	Nil: DC - 0.9W AC – 2VA L: DC - 0.6W

DIMENSIONS (unit: mm)

Type 1

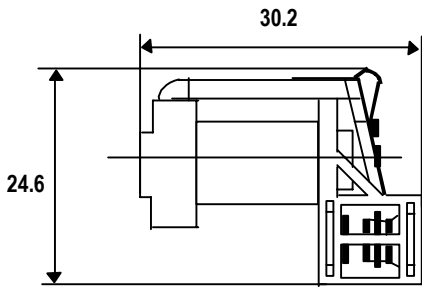
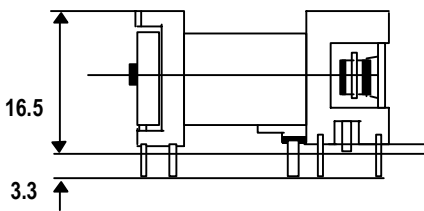

Sealed / Dust Cover

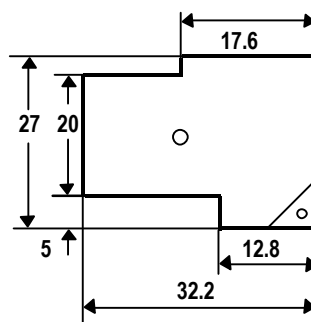
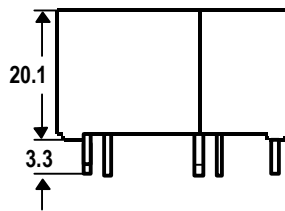

SCHEMATIC

6 Terminals

5 Terminals

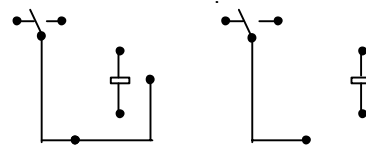
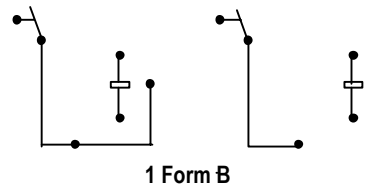
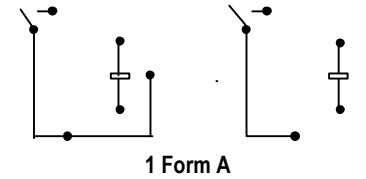

PCB Layout

6 Terminals

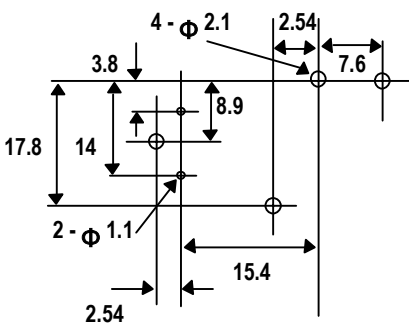

5 Terminals

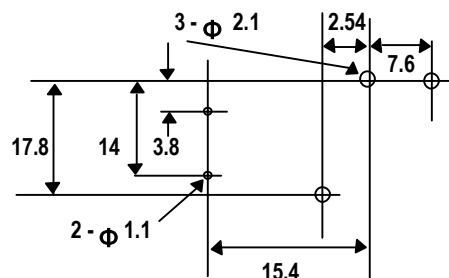

DIMENSIONS (unit: mm)

Outline Dimension

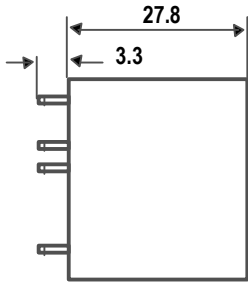

Type 2

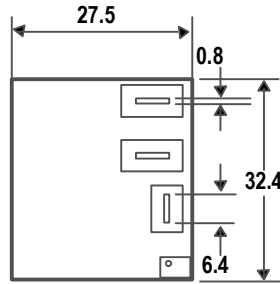

Type 3

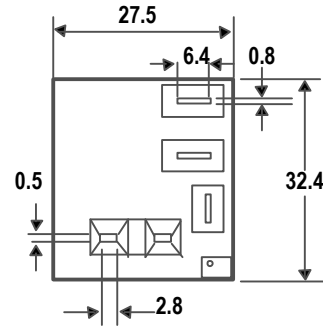

PCB Layout

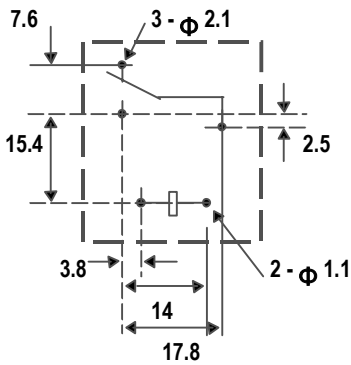

Type 4 - Outline Dimension

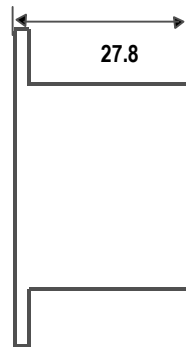

Type 5

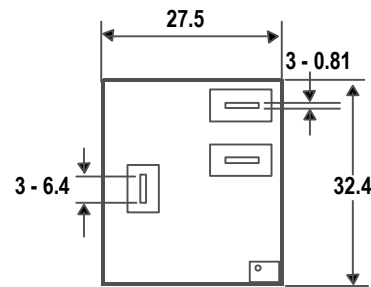

Type 4 - 1/9 coil terminals

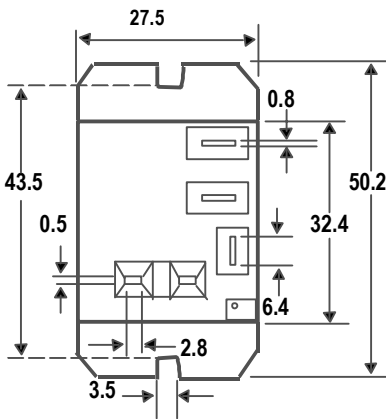

Type 4 - 3/16 coil terminals

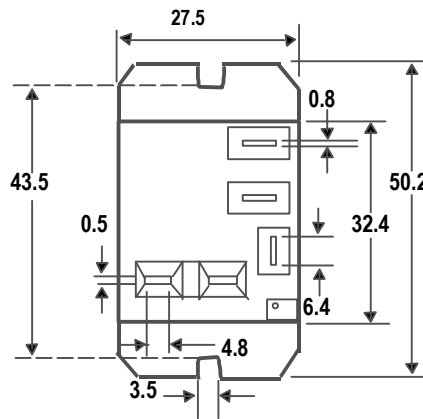

Type 6

